



High Point Christian School

an Impact Christian School

Our Vision Statement:

Our Vision is to educate students to be servant leaders who impact the world for the glory of God.



Welcome New and Returning Families!

Staff Introductions

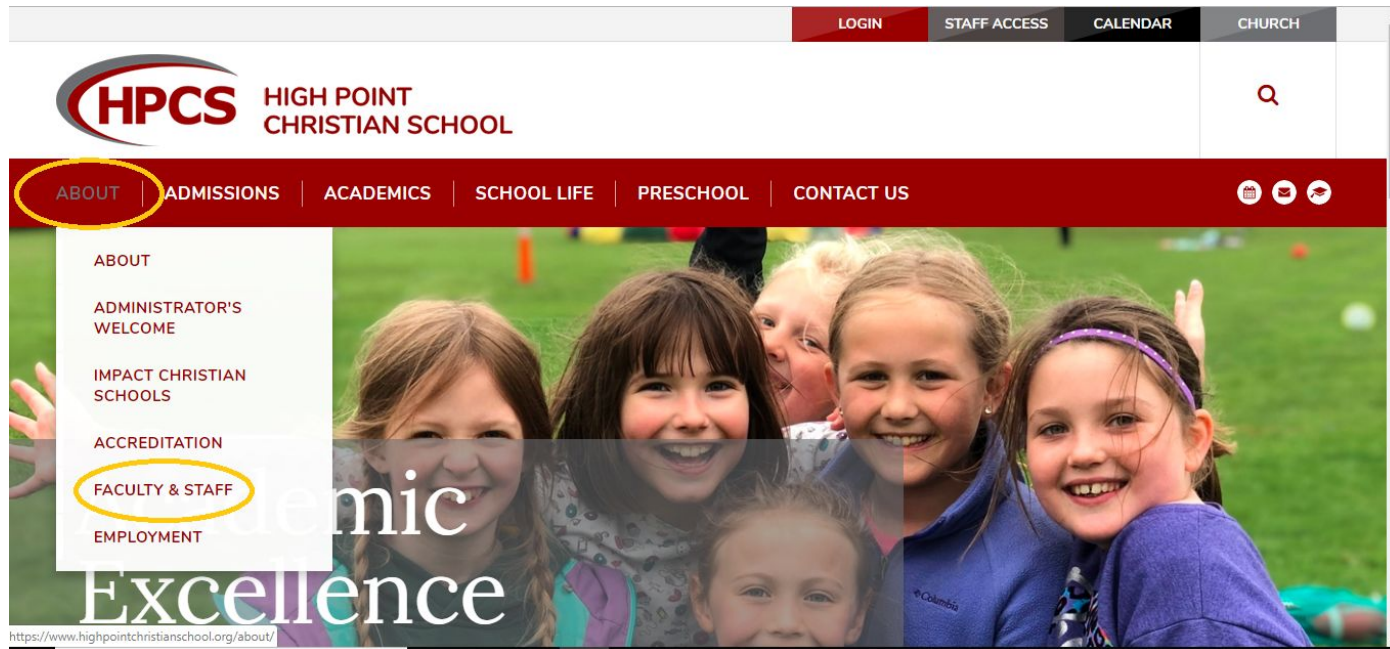



Campus Advisory Committee Prayer for New School Year

Frank Pekovich

Campus Advisory Committee



- ❖ Dave Wilke - Chair, High Point Church Elder
- ❖ Luke Anderson - HPCS Principal
- ❖ Frank Pekovich - HPC Elder
- ❖ Monte Knetter - HPC Elder
- ❖ Kris Peppler - HPC/HPCS Librarian; HPC Member
- ❖ Chuck Moore - Executive Director of Impact Christian Schools
- ❖ Elizabeth MacKenzie - HPCS Parent
- ❖ Cindy Kunde - retired HPCS Faculty; HPCS Grandparent
- ❖ Mark MacKenzie - HPCS Parent

ALL-CHURCH BBQ

A stylized illustration of a hot dog and a burger with flames. The hot dog is positioned above the burger, and both are rendered in a simplified, graphic style. The background behind the food items consists of stylized flames in shades of orange and yellow.

SEPTEMBER 10 // 10AM - 2:30PM

MEAL OPTIONS: \$10 BBQ meal
\$5 hot dog meal
\$40 per family

SCHOLARSHIPS
AVAILABLE

2023-24 Spiritual Emphasis: *Every Thought Captive*



Verse: “We demolish arguments and every pretension that sets itself up against the knowledge of God, and we take captive every thought to make it obedient to Christ.” 2 Corinthians 10:5

Main idea: Considering the constant battle for our attention, we must deliberately choose obedience to Christ, grounded in Scripture and active faith, armed with the power to dismantle cultural falsehoods, replacing negativity with goodness.

Essential Question: How can we actively apply the idea of "Every Thought Captive" to our friendships, decisions, and actions, and what impact can this have on our lives and on those around us?



School Schedule

- ❖ Doors open at 7:50 a.m.; **NO EARLY DROP-OFFS**
- ❖ Day begins at 8:00 a.m.
- ❖ Specific period times are listed in the HPCS Family Handbook
- ❖ Students released at 3:23 p.m.
- ❖ PLEASE NOTE - the release time for half days this year will be 12:10.



Morning Drop-Off

- ❖ Preschool enters at the main school entrance
- ❖ Kindergarten drop-off at the main school entrance
- ❖ 1st-4th grade drop-off at the 1st grade doors
- ❖ 5th-8th grade drop-off at the Micah E doors on the west end of the building
- ❖ SEE MAP

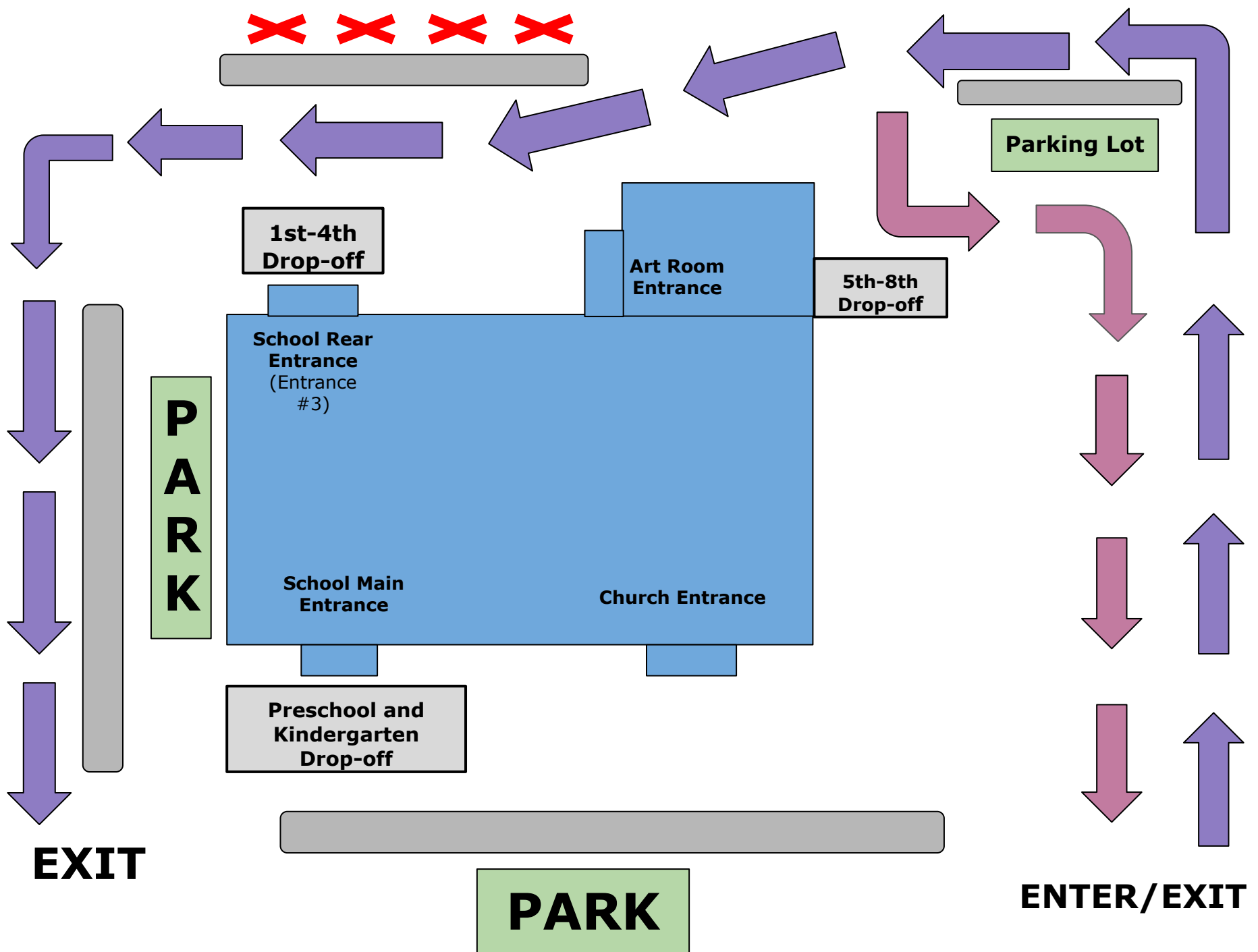



First Day of School

- August 30th for Preschool - 8th
- Parents may walk students (1st day only) into school (Kindergarten as needed through 3rd quarter)
- Preschool parents walk preschool students in every day
- Older siblings should continue to their homerooms independently



Protocol During Carpool (ES)

Option #1 Assemble in Carpool Line

- Have your yellow family name tag visible on your visor.
- Follow the direction of traffic for student safety.
- Teachers in K-2 will bring your child(ren) to cars. Please do not get out of your vehicle.
- Pull to the front lot if you need to buckle your child.

Option #2 Park & Pick Up Students in Carpool Area

- Use Sidewalk
- No Pets

* Buses for After School Care

- Students will be taken to pick up location.

Protocol During Carpool (MS)



Option #1 (Only Middle School Students)

- If you only have a student(s) in MS (5-8) please park in the first tier parking lot in the front of the building (behind Old Sauk Road)
- Your MS student will walk out the church doors and proceed to your vehicle.

Option #2 (Middle School and Elementary Students)

- (Preferred) Park in the first tier lot and gather your MS student(s), then enter the K-4 line to get your ES student(s). **OR**
- Enter the carpool line, gather your ES student(s) then pull around to the front of the building and gather your MS student(s)



Family Handbook Updates



Absences

- ❖ Section 5.11
- ❖ Leaving Early?
 - MS - email office AND middleschool@hpcsmadison.org
 - PS, ES - email office AND homeroom teacher

Excused Travel Absence



- ❖ Section 5.12
- ❖ Limited to 10 days per year
- ❖ Homework make-up due to travel policy
- ❖ Form is available on the Family Portal

Requesting Homework When Your Student is Absent due to Illness



- ❖ Section 6.3
- ❖ MS - email middleschool@hpcsmadison.org before 8:45; homework will be ready for pick-up at 3:15
- ❖ Grades 3-4 - email the homeroom teacher before 8:45; homework will be ready for pick-up at 3:15
- ❖ Grades K-2 - work will be made up when your student returns to school

Alternate arrangements will be made for students absent due to illness for an extended period of time.

Who to Contact



- ❖ Section 7.7
- ❖ Who to contact regarding academic and grading concerns, homework questions, discipline issues, etc



Family Handbook Reminders

Personal Electronic Devices



Any device that

- ❖ displays a message or video image
- ❖ is capable of receiving, sending, emitting, photographing, or storing any video communication, files, or data.
- ❖ Includes, but is not limited to items that allow the student to access the internet, or an accessory to any such device such as earphones or Bluetooth devices.
- ❖ Exclusions for medically necessary devices, with appropriate documentation from a physician, will be handled on a case by case basis.

Personal Electronic Devices



Grades K-4th:

No personal electronic devices are allowed at school.

Personal Electronic Devices



Grades 5th-8th:

Personal electronic devices **may not** be used by students inside the school during school hours. Each middle school homeroom will have their own designated “phone tree.” Students must place all cell phones, smart watches, etc. in the classroom phone tree at the beginning of the school day with the device turned off.

Mrs. Krumbach will have more information.

HPCS Dress Code



- ❖ The HPCS dress code applies to all K-8th students.
- ❖ Full text of the dress code policy can be found in the HPCS Family Handbook
- ❖ The following are some important highlights...



Sleeveless shirts are acceptable but the shoulder must be at least three fingers wide.



Ripped jeans may be worn only if rips are at or below the fingertips (arms straight down at side).



Leggings, yoga, and other tight fitting pants may be worn, but only with a top that covers 360 degrees at a length at or below the student's knuckles when the student's arms are extended straight down at their side and hands are in a fist, without pulling or tugging



Shorts, at or below fingertip length when the hand is flat against the leg, may be worn. No spandex shorts.



Hooded sweatshirts must be worn with the hood down while inside the school.

Lunchroom



Anne Yaroch ayaroch@hpcsmadison.org

- **Lunch ordering** - Due by end of the day **TODAY**
- **Milk**
- **Lunch ordered but student is absent**
- **Lunchroom volunteers**
 - 4 per family





Student Services

Contact Information:

Sheila Olson, Director of Student Services

solson@hpcsmadison.org

Sports Currently Offered



- ❖ Flag Football
- ❖ Girls Basketball
- ❖ Girls Volleyball
- ❖ Boys Volleyball
- ❖ Cross Country
- ❖ Softball
- ❖ Boys Basketball
- ❖ Track and Field

Contact Information

- Athletic Director: Mike Asen
- Email: masen@hpcsmadison.org

Register your student for athletics today!



Office Protocols

- Office email address is office@hpcsmadison.org
- How to handle:
 - Advanced absence requests
 - Sick child notification
 - Early pickup
 - Alternate pickup arrangements
 - After school care (please notify office)

There's an app for that!

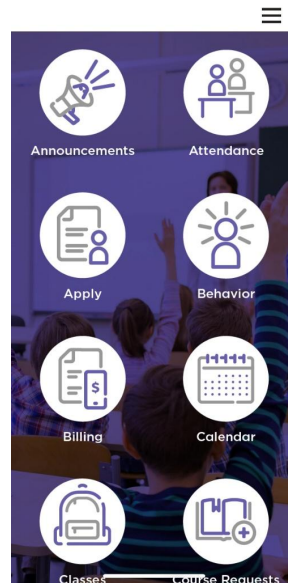
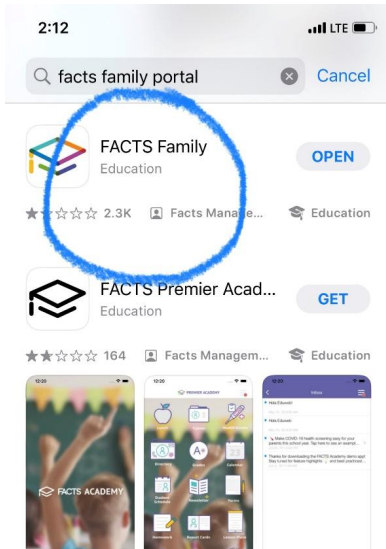

- Order Hot Lunch
- See newest announcements
- Grades
- Schedules
- Calendar
- Directory
- Homework
- Update medical and family information

Box Tops



READY TO START EARNING FOR SCHOOLS?

GET THE BOX TOPS APP TODAY!

In order to earn cash for your school, you'll need to use the Box
Tops app on your mobile device.



www.boxtops4education.com

Parent Support Organization



The PSO provides support to HPCS faculty, staff, students and families through

- ❖ community building events (i.e., dinner nights)
- ❖ staff appreciation

Room Parents



Ideally we would have two parents assigned to each homeroom class.

Duties include:

- ❖ Working with the homeroom teacher to plan parties and other special events
- ❖ Planning very low-key social get togethers for the class outside of school
- ❖ Assisting the homeroom teacher as requested
- ❖ Sign up in the gym tonight or email the office



Covid Update

Schedule for Tonight



- ❖ 7:20- 7:50pm - Classroom Session #1
- ❖ 8:00- 8:30pm - Classroom Session #2
- ❖ Tables for Specials, lunchroom, and athletics will be available in the gym throughout the evening until 8:45pm